

# Commons – 210 Grand Ballroom

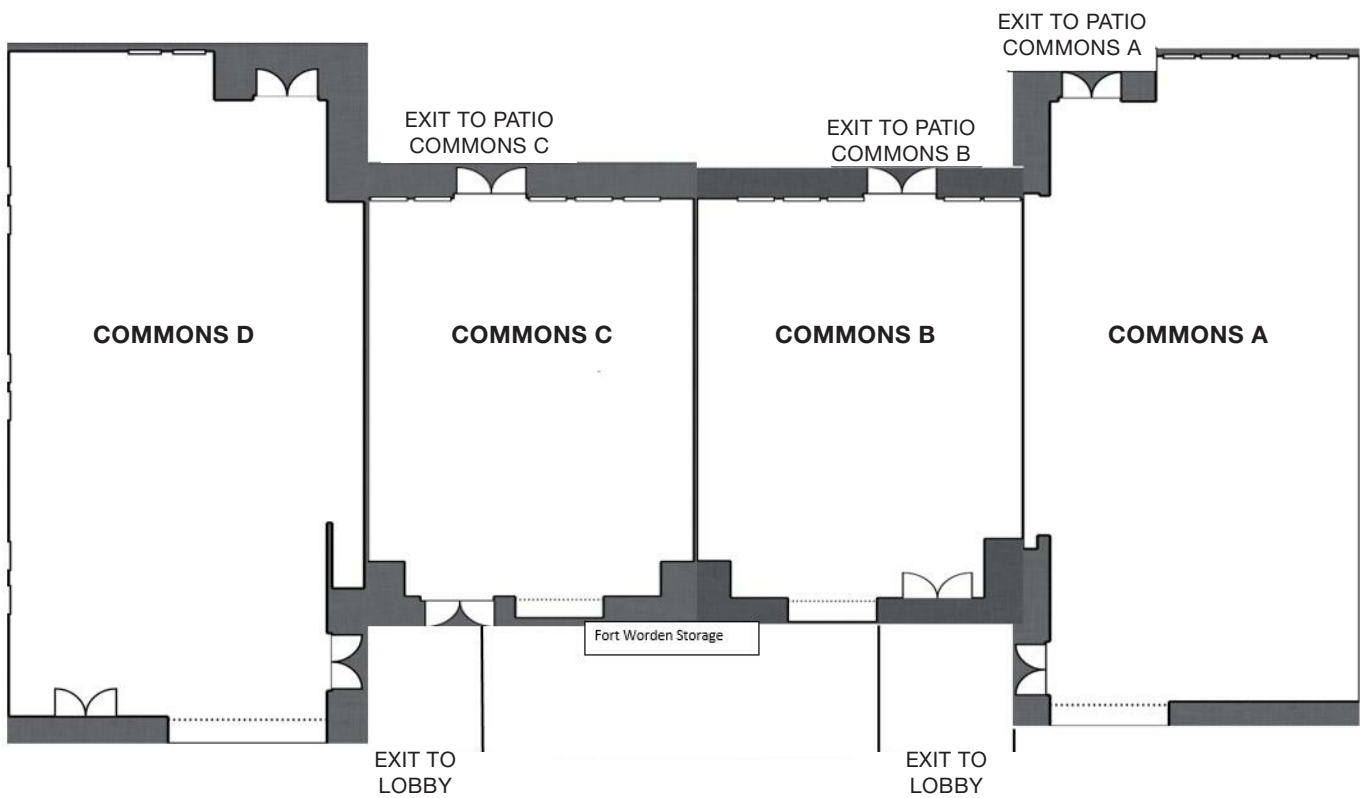

*Fort Worden*

— PORT TOWNSEND —  
A HISTORIC GATHERING PLACE



# Commons A



*Fort Worden*

PORT TOWNSEND  
A HISTORIC GATHERING PLACE

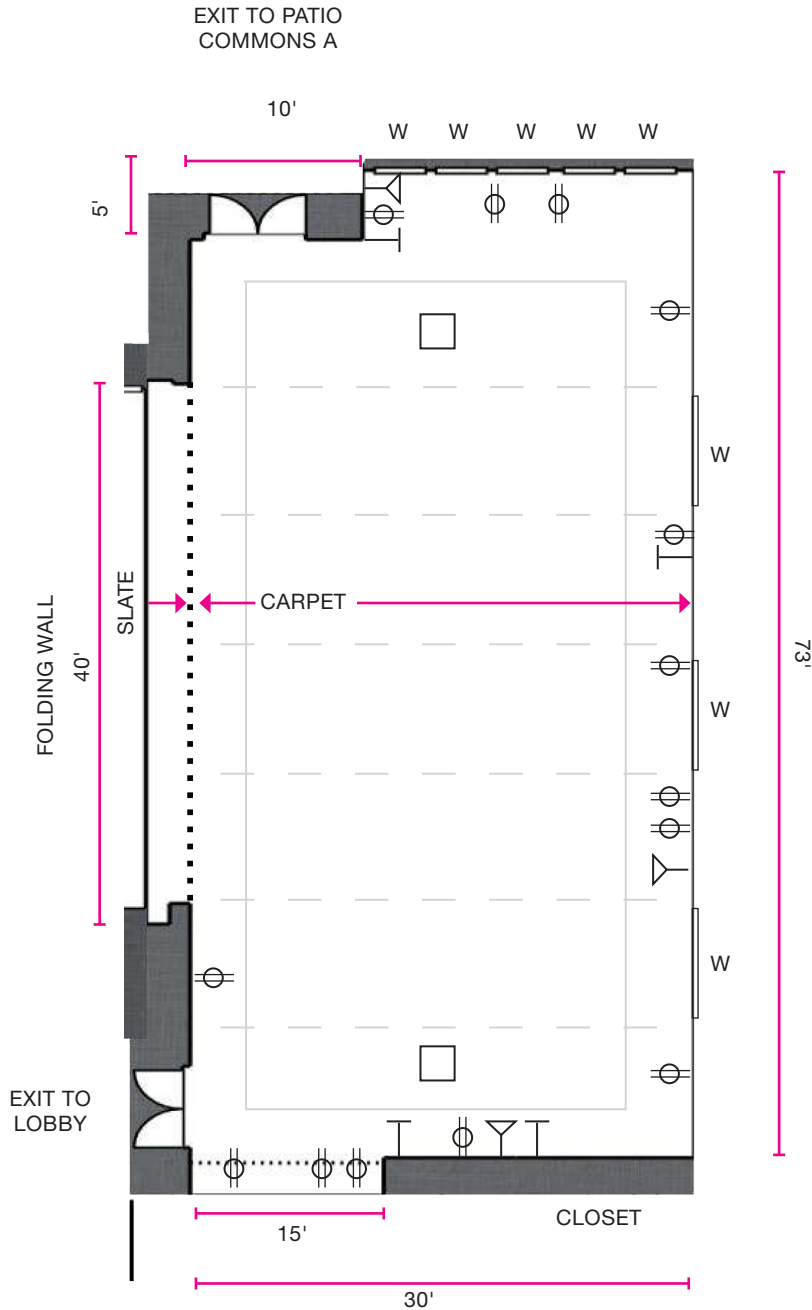

## ROOM AREAS

Main Space 2250 SF

Dimensions 30' x 73'

## ROOM DETAILS

CEILING  
MATERIAL

CEILING Cathedral

FLOOR  
MATERIAL Carpet & Slate

WALL  
MATERIAL Folding wall is vinyl

LIGHTS Pendant

BLINDS Power blinds

MISC Recessed wet bar

ACCESS 6' W x 7' H

### TABLES & CHAIRS

6 Standard Banquet  
72" (6ft) X 30"

12 Round Banquet 60" (5ft)

72 Chairs

⊕ Power Outlet

⌵ Lighting

⌵ Audio

□ Floor Box

# Commons B



*Fort Worden*

PORT TOWNSEND  
A HISTORIC GATHERING PLACE

## ROOM AREAS

Main Space 1107 SF

Dimensions 27' x 41'

## ROOM DETAILS

CEILING MATERIAL

CEILING Cathedral

FLOOR MATERIAL Carpet & Slate

WALL MATERIAL Folding wall is vinyl

LIGHTS Cove lighting at ceiling  
Down light in center



BLINDS Power blinds

DRY BAR Recessed

FOLDING WALL Vinyl surface

ACCESS 6'W x 7'H

### TABLES & CHAIRS

-  3 Standard Banquet 72"(6ft) X 30"
-  7 Round Banquet 60" (5ft)
-  60 Chairs

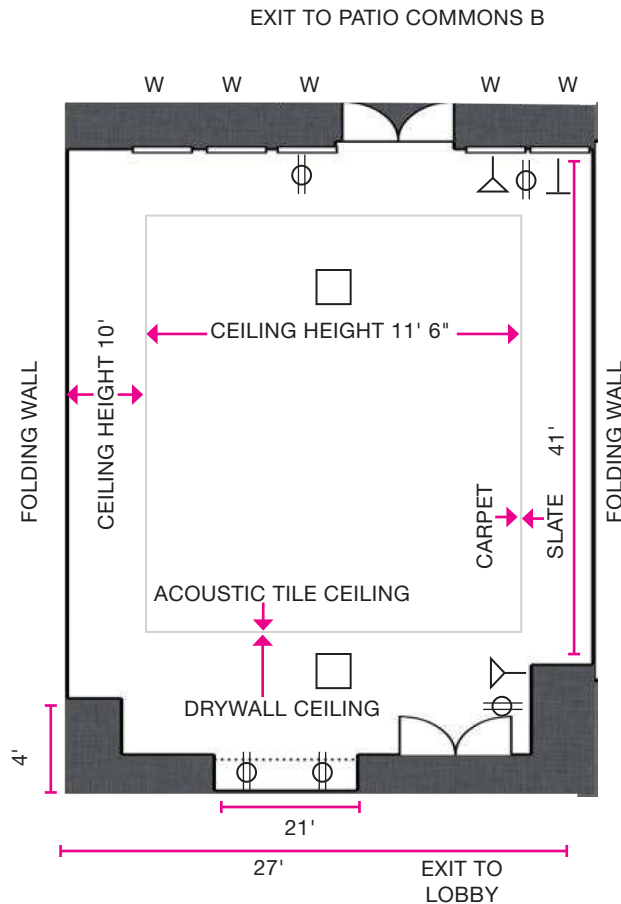

 Power Outlet

 Lighting

 Audio

 Floor Box

# Commons C



*Fort Worden*

PORT TOWNSEND  
A HISTORIC GATHERING PLACE

## ROOM AREAS

Main Space 1107 SF

Dimensions 27' x 41'

## ROOM DETAILS

CEILING MATERIAL

CEILING Cathedral

FLOOR MATERIAL Carpet & Slate

WALL MATERIAL Folding wall is vinyl

LIGHTS Cove lighting at ceiling  
Down light in center

BLINDS Power blinds

DRY BAR Recessed

FOLDING WALL Vinyl surface

ACCESS 6'W x 7'H

### TABLES & CHAIRS

3 Standard Banquet  
72" (6ft) X 30"

7 Round Banquet 60" (5ft)

60 Chairs

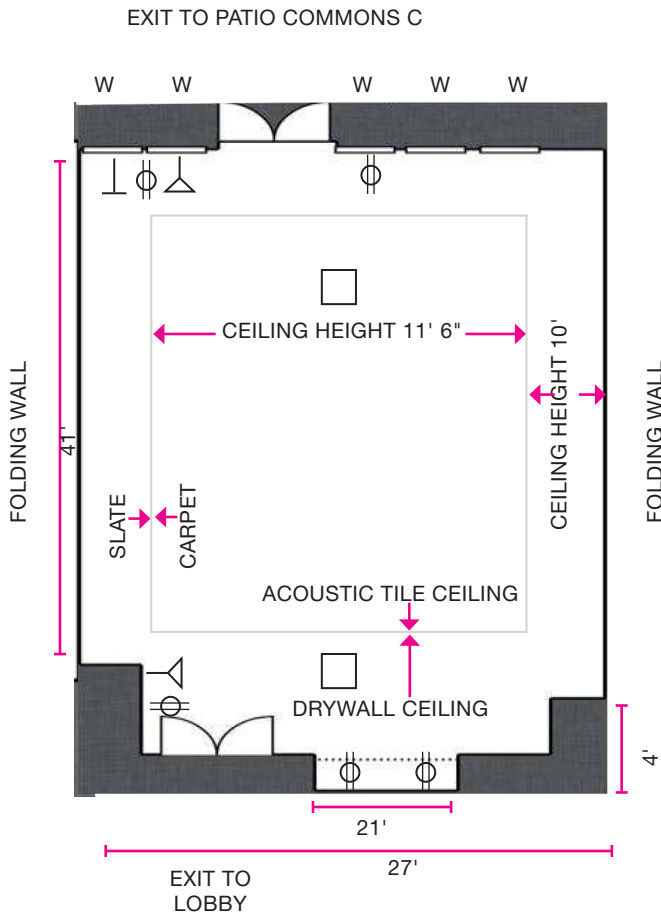

⊕ Power Outlet

⌵ Lighting

⌵ Audio

□ Floor Box

# Commons D



*Fort Worden*

PORT TOWNSEND  
A HISTORIC GATHERING PLACE

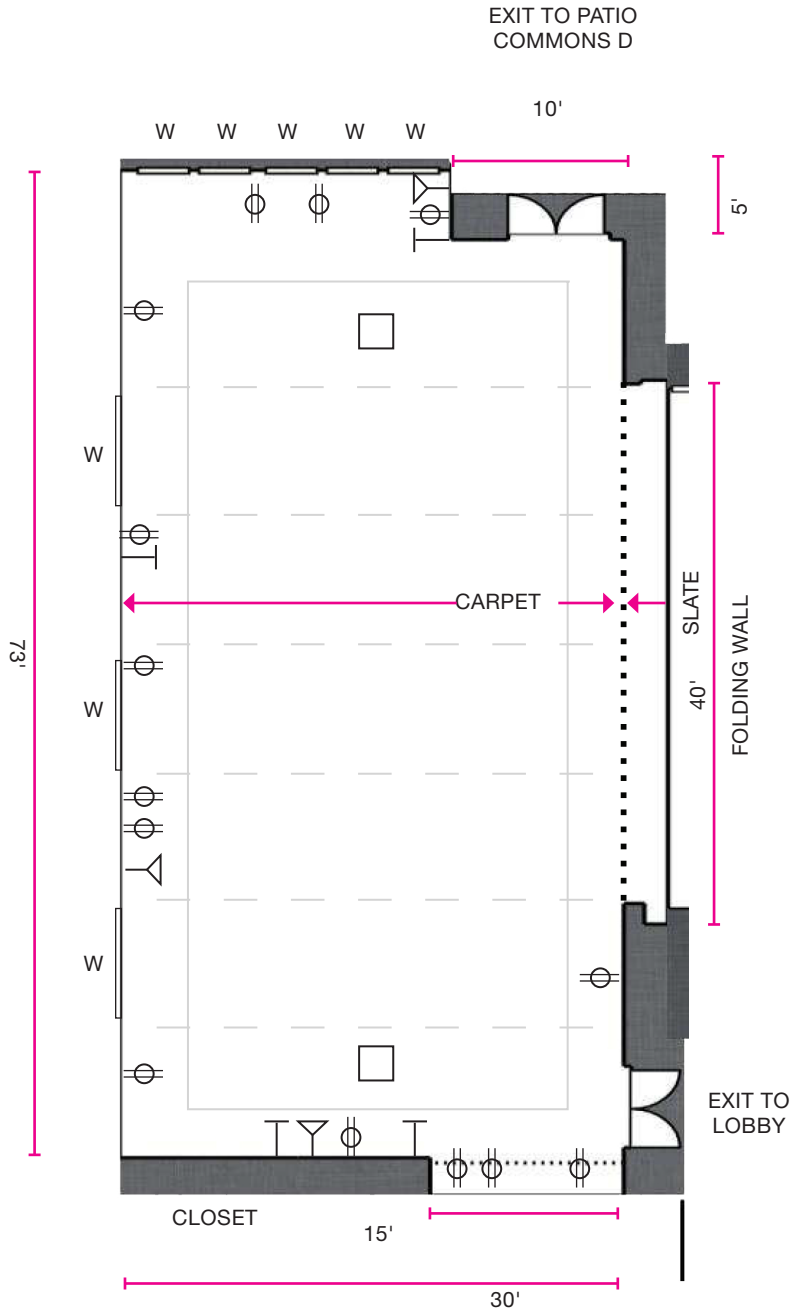

## ROOM AREAS

Main Space 2250 SF  
Dimensions 30' x 73'

## ROOM DETAILS

CEILING  
MATERIAL

CEILING Cathedral

FLOOR  
MATERIAL Carpet & Slate

WALL  
MATERIAL Folding wall is vinyl

LIGHTS Pendant

BLINDS Power blinds

MISC Recessed wet bar

ACCESS 6' W x 7' H

### TABLES & CHAIRS

6 Standard Banquet  
72" (6ft) X 30"

12 Round Banquet 60" (5ft)

72 Chairs

⊕ Power Outlet

∇ Lighting

T Audio

□ Floor Box

# Commons Lobby



*Fort Worden*

PORT TOWNSEND  
A HISTORIC GATHERING PLACE

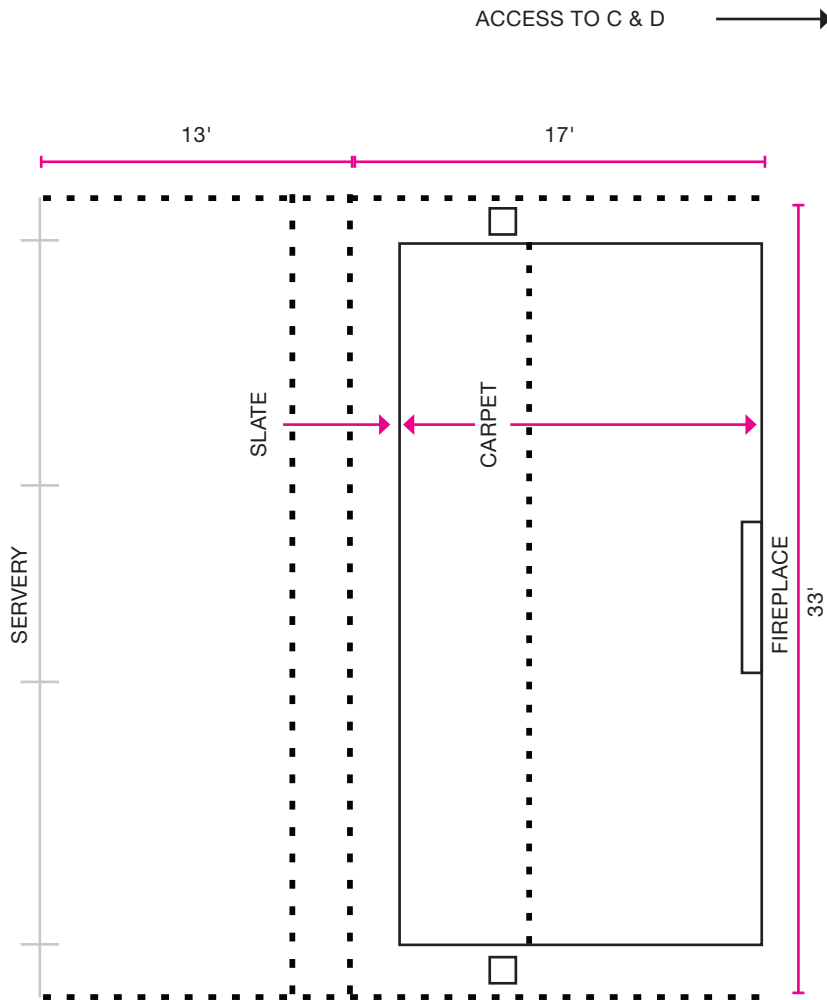

## ROOM AREAS

Main Space 561 SF  
Dimensions 17' x 33'

## ROOM DETAILS

### CEILING MATERIAL

CEILING Translucent Skylight

FLOOR MATERIAL Carpet & Slate

WALL MATERIAL Plasterboard

LIGHTS Pendant

### TABLES & CHAIRS

 Standard Banquet  
72" (6ft) X 30"

 Round Banquet 60" (5ft)

 Chairs

ENTRY



ACCESS TO A & B



 Power Outlet

 Lighting

 Audio

 Floor Box

# Commons Patio



*Fort Worden*

PORT TOWNSEND  
A HISTORIC GATHERING PLACE

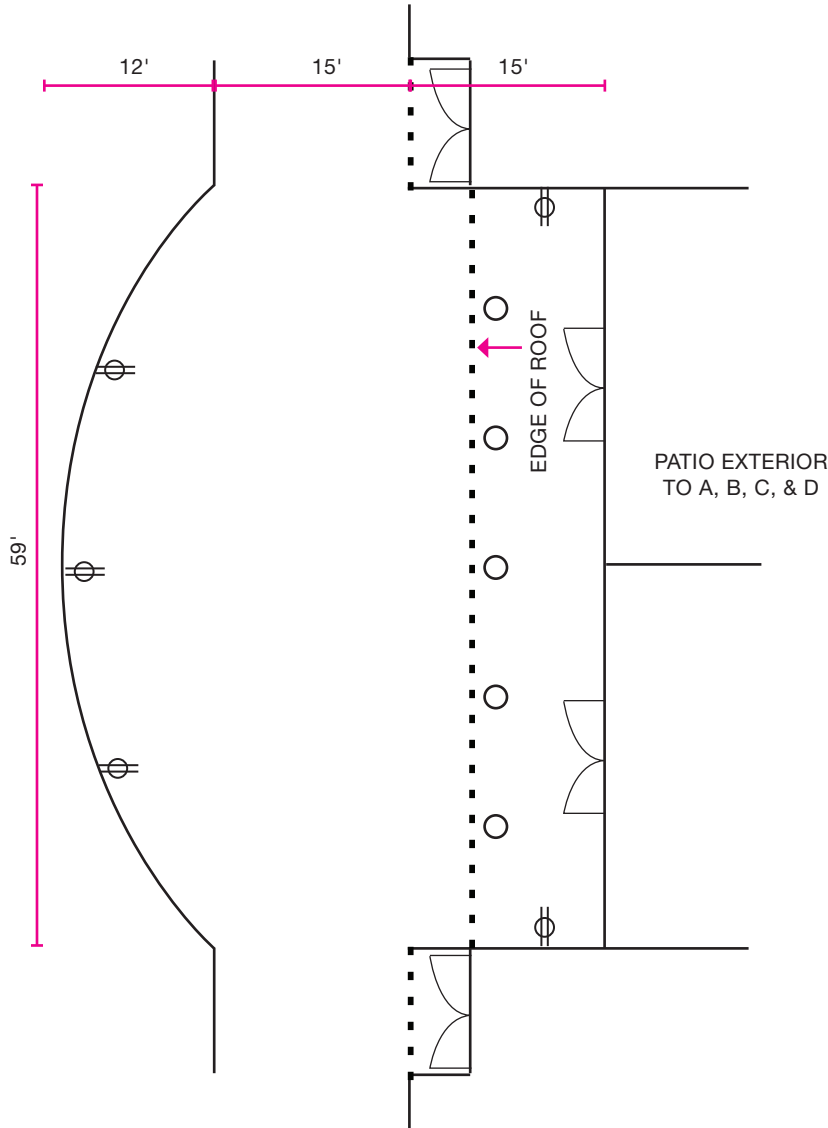

## ROOM AREAS

Main Space 2124 SF

Dimensions 15' x 59'

## ROOM DETAILS

CEILING  
MATERIAL

CEILING Translucent Skylight



FLOOR  
MATERIAL Concrete

WALL  
MATERIAL Plasterboard

LIGHTS Pendant

### TABLES & CHAIRS

 Standard Banquet  
72" (6ft) X 30"

 0 Round Banquet 60" (5ft)  
 Chairs

 Power Outlet

 Lighting

 Audio

 Floor Box

 Columns